

# PrinGroup

COMMERCIAL

## FOR LEASE

12011 WESTBRAE PARKWAY  
HOUSTON TX, 77031

12011 WESTBRAE PKWY  
HOUSTON TX, 77031

- **15,500SF DISTRIBUTION OFFICE/WAREHOUSE IN SW HOUSTON**
- FACILITY BUILT IN 2008 WITH EXPANSION IN 2016
- (2) DOCK-HIGH DOORS, (1) GRADE-LEVEL
- FULLY FENCED & SPRINKLERED WAREHOUSE
- 3PH POWER; 18' – 26' CLEAR HEIGHT
- EASY ACCESS TO BELTWAY 8, HWY 59, & WESTPARK TOLLWAY
- INDUSTRIAL GROSS LEASE

18000 GROESCHKE, SUITE A7  
HOUSTON, TX 77084

[WWW.PRINGROUP.COM](http://WWW.PRINGROUP.COM)



**Steven O'Connor**

713-300-4081

[steven@pringroup.com](mailto:steven@pringroup.com)

**Marc Lawson**

713-300-1450

[marc@pringroup.com](mailto:marc@pringroup.com)

PrinGroup  
COMMERCIAL

THE INFORMATION CONTAINED HEREIN IS OBTAINED FROM SOURCES BELIEVED TO BE RELIABLE. HOWEVER, PRINGROUP COMMERCIAL MAKES NO GUARANTEE, WARRANTIES OR REPRESENTATIONS AS TO THE COMPLETENESS OR ACCURACY THEREOF. THE PRESENTATION OF THIS PROPERTY IS SUBMITTED SUBJECT TO ERRORS, OMISSIONS, CHANGE OF PRICE OR CONDITIONS AND IS SUBJECT TO PRIOR SALE, LEASE OR WITHDRAWAL WITHOUT NOTICE

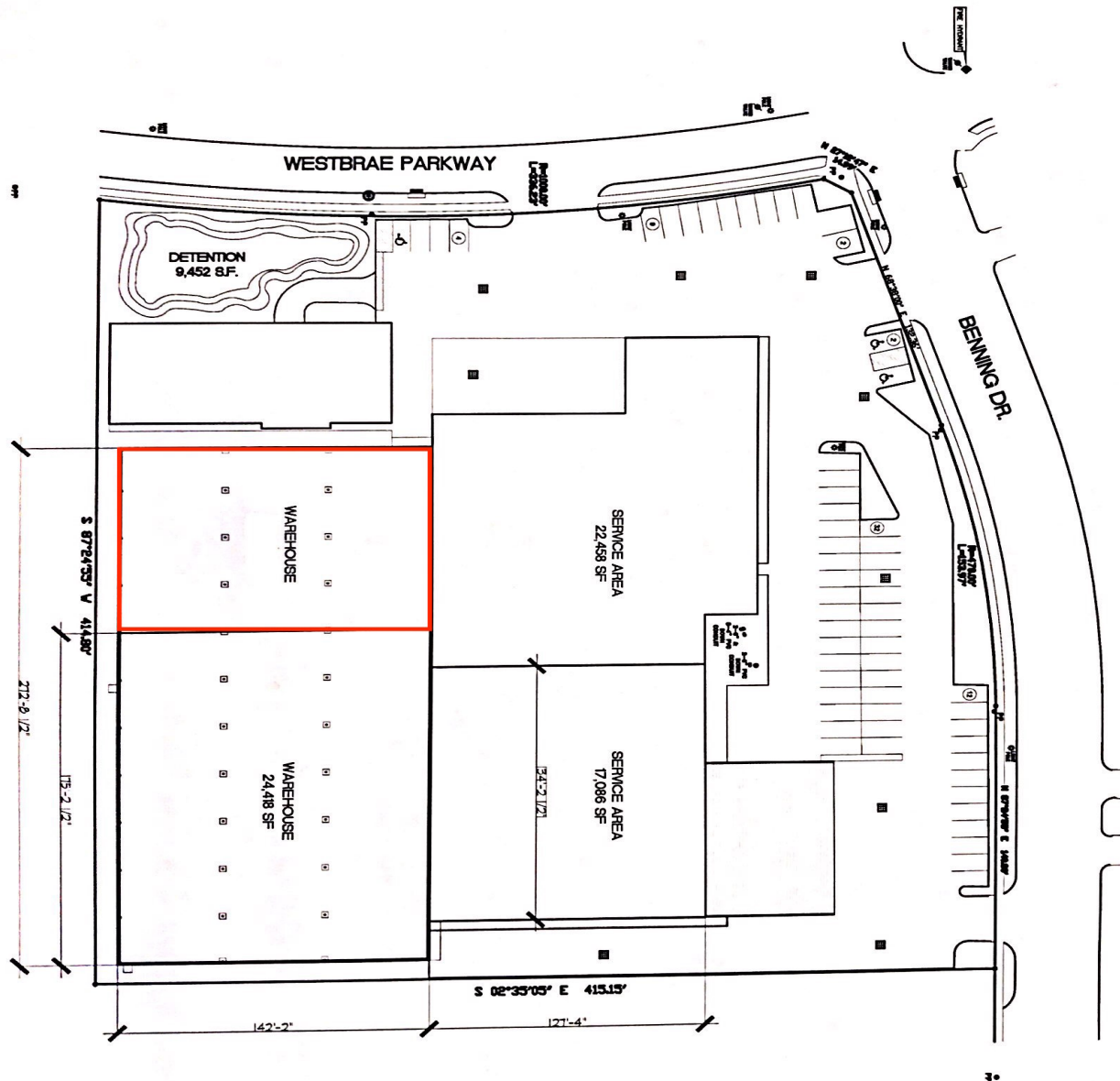

**Steven O'Connor**

713-300-4081

[steven@pringroup.com](mailto:steven@pringroup.com)

**Marc Lawson**

713-300-1450

[marc@pringroup.com](mailto:marc@pringroup.com)